

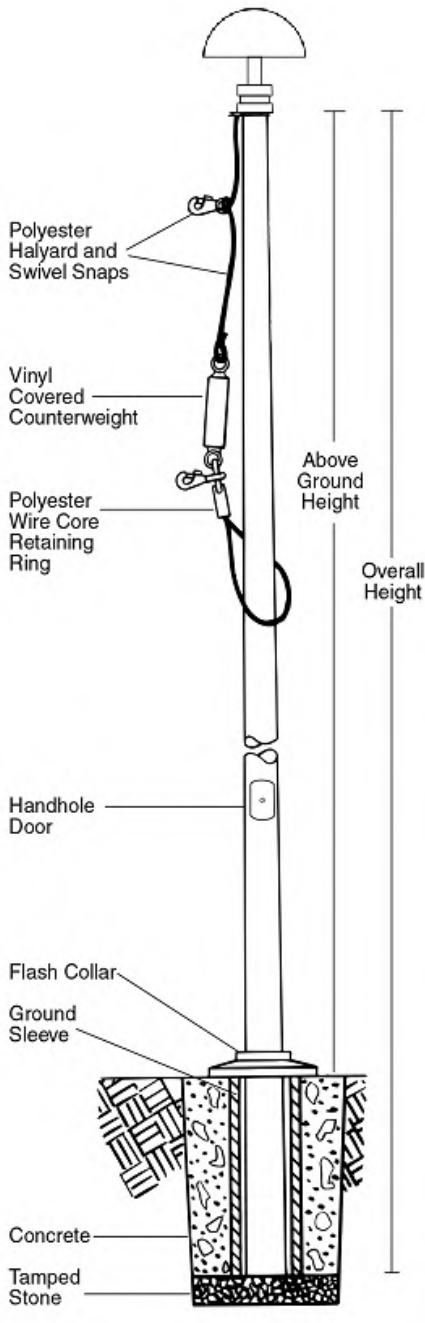

# Internal Halyard Ground Set 20'-40' (50', Shoe Base, & Hinge Base cont.)

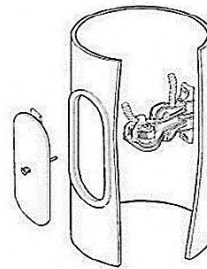

**Internal Cam Cleat  
and hand hole door**



| Model                  | 20I   | 25I   | 30I   | 35I   | 40I    |
|------------------------|-------|-------|-------|-------|--------|
| Above Ground Height    | 20'   | 25'   | 30'   | 35'   | 39'    |
| Overall Height         | 23'   | 28'   | 33'   | 39'   | 43'    |
| Butt Diameter          | 5.75" | 6"    | 6.75" | 7"    | 7"     |
| Top Diameter           | 3"    | 3"    | 3"    | 3"    | 3"     |
| Pole Weight (lbs.)     | 36    | 59    | 77    | 115   | 137    |
| Shipping Weight (lbs.) | 105   | 113   | 151   | 197   | 219    |
| Ground Sleeve I.D.     | 8"    | 8"    | 8"    | 8"    | 8"     |
| Ground Sleeve Length   | 3'    | 3'    | 3'    | 4'    | 4'     |
| Halyard                | #10   | #10   | #10   | #10   | #10    |
| Flash Collar           | 16"   | 16"   | 16"   | 16"   | 16"    |
| Snaps                  | Brass | Brass | Brass | Brass | Brass  |
| Standard Flag Size     | 4'x6' | 4'x6' | 5'x8' | 5'x8' | 6'x10' |

## Specifications

Provide a Fiberglass Reinforced Composite (FRC) Ground set flagpole Model # 20I as manufactured by PLP Composites, Fitzwilliam, NH 03447.

The flagpole shall have a mounting height of 20' and 3' below grade for an overall length of 23'. The butt diameter shall be 5.75" and the top diameter 3". The pole weight shall be approximately 36 lbs. and a total shipping weight of 105 lbs.

The flagpole shall be manufactured of fiberglass woven roving and polyester resin with 75% of the reinforcing fibers oriented in the axial plane for maximum stiffness and 25% in the radial plane for required hoop strength. Load calculations shall be based on AASHTO and NAAMM standards with the pole designed with a two to one (2:1) safety factor for 125 mph windspeed, unflagged, with a 1.3 gust factor.

The flagpole shall have an Entasis taper and shall be void of vertical mold seams.

The flagpole shall be sanded smooth and coated with a high gloss Aliphatic Polyurea coating system which provides extended UV protection and weatherability.

The color of the flagpole shall be:

Standard: white, bronze, black or other, as specified \_\_\_\_\_ (select one)

The flagpole shall be equipped with PLP standard fittings:

- #10 (5/16") polyester halyard
- wire core retaining ring
- vinyl covered counterweight
- stainless steel and nylon internal cam cleat
- hand hole door with security system
- security driver to access hand hole
- a 16" composite flash collar
- a pair of brass snaps with vinyl covers
- 3' x 8" fiberglass ground sleeve



# Internal Halyard Ground Set, 50' (Shoe Base & Hinge Base cont.)

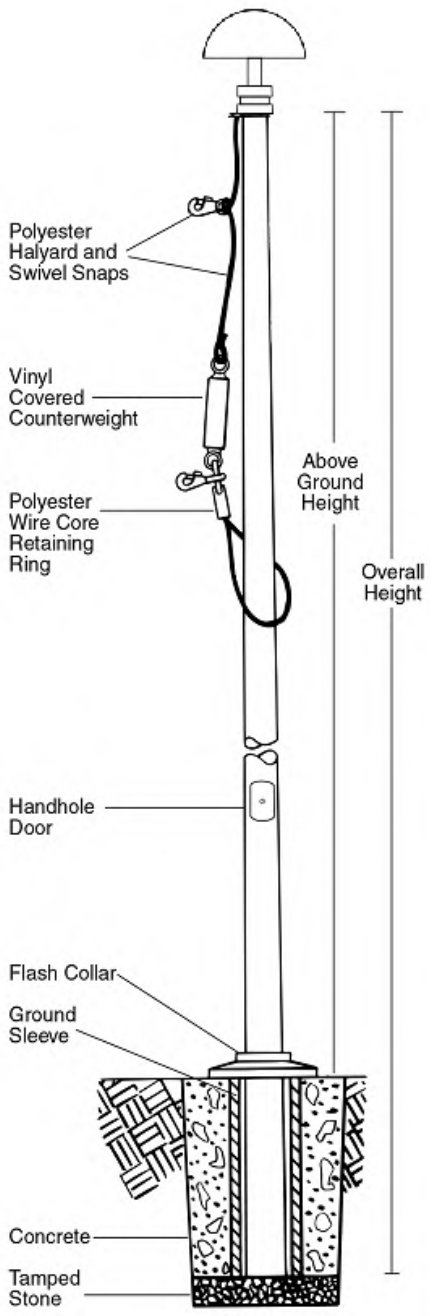

**Internal Winch**  
Front View

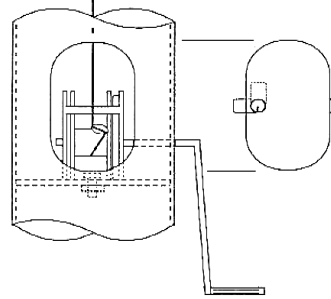

|                        |           |
|------------------------|-----------|
| Model                  | 50I       |
| Above Ground Height    | 50'       |
| Overall Height         | 55'       |
| Butt Diameter          | 10"       |
| Top Diameter           | 4.5"      |
| Pole Weight (lbs.)     | 325       |
| Shipping Weight (lbs.) | 577       |
| Ground Sleeve I.D.     | 14"       |
| Ground Sleeve Length   | 5'        |
| Halyard                | S/S Cable |
| Flash Collar           | 23"       |
| Snaps                  | S/S       |
| Standard Flag Size     | 8'x12'    |

## Specifications

Provide a Fiberglass Reinforced Composite (FRC) Ground set flagpole Model # 50I as manufactured by PLP Composites, Fitzwilliam, NH 03447.

The flagpole shall have a mounting height of 50' and 5' below grade for an overall length of 55'. The butt diameter shall be 10" and the top diameter 4.5". The pole weight shall be approximately 325 lbs. and a total shipping weight of 577 lbs.

The flagpole shall be manufactured of fiberglass woven roving and polyester resin with 75% of the reinforcing fibers oriented in the axial plane for maximum stiffness and 25% in the radial plane for required hoop strength. Load calculations shall be based on AASHTO and NAAMM standards with the pole designed with a two to one (2:1) safety factor for 125 mph windspeed, unflagged, with a 1.3 gust factor.

The flagpole shall have an Entasis taper and shall be void of vertical mold seams.

The flagpole shall be sanded smooth and coated with a high gloss Aliphatic Polyurea coating system which provides extended UV protection and weatherability.

The color of the flagpole shall be:

Standard: white, bronze, black or other, as specified \_\_\_\_\_ (select one)

The flagpole shall be equipped with PLP standard fittings:

- stainless steel aircraft cable
- wire core retaining ring
- vinyl covered counterweight
- stainless steel internal winch with hand crank
- hand hole door with cylinder cam lock & keys
- composite flash collar
- stainless steel swivel snaps with vinyl covers
- fiberglass ground sleeve



# Internal Halyard Shoe Base (Hinge Base cont.)

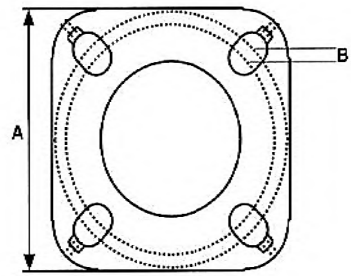
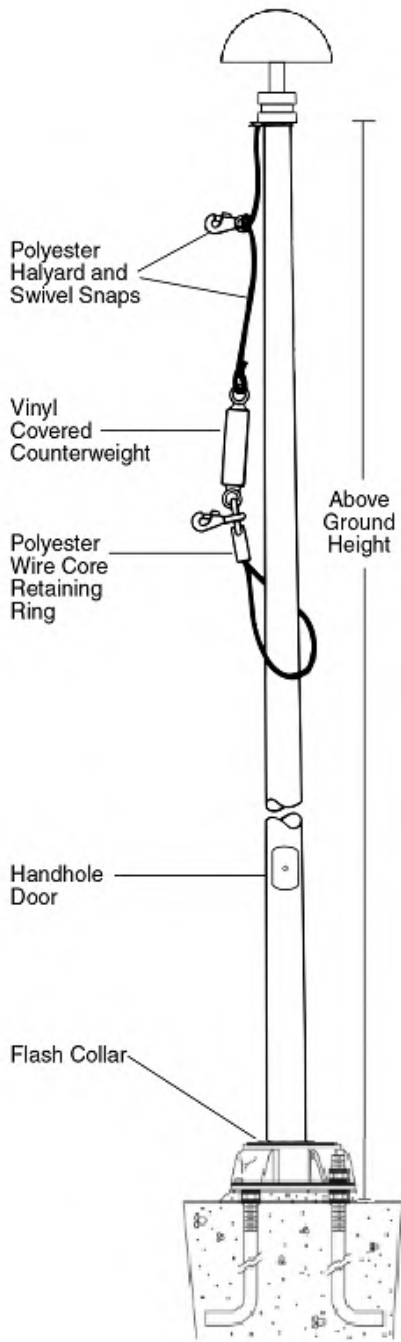

| Model                              | AB20I   | AB25I      | AB30I      | AB35I      |
|------------------------------------|---------|------------|------------|------------|
| Above Ground Height                | 20'     | 25'        | 30'        | 35'        |
| Butt Diameter                      | 5.75"   | 6.5"       | 6.5"       | 7"         |
| Top Diameter                       | 3"      | 3"         | 3"         | 3"         |
| Pole Weight with base (lbs.)       | 41      | 61         | 78         | 97         |
| Shipping Weight with base (lbs.)   | 105     | 113        | 151        | 197        |
| Cleat                              | 8.5" NY | 8.5" NY    | 8.5" NY    | 8.5" NY    |
| Halyard                            | #10     | #10        | #10        | #10        |
| Snaps                              | Brass   | Brass      | Brass      | Brass      |
| Anchor Bolt length (sold separate) | 24"     | 24"        | 24"        | 24"        |
| Bolt Diameter                      | 3/4"    | 3/4"       | 3/4"       | 3/4"       |
| Exposed Thread Projection          | 2.75"   | 2.75"      | 2.75"      | 2.75"      |
| Bolt Circle (B)                    | 8"-9"   | 9"-11"     | 9"-11"     | 9"-11"     |
| Base Width (A)                     | 9" sq.  | 10.24" sq. | 10.24" sq. | 10.24" sq. |
| Standard Flag Size                 | 4'x6'   | 4'x6'      | 5'x8'      | 5'x8'      |

## Specifications

Provide a Fiberglass Reinforced Composite (FRC) Anchor Base Flagpole Model # AB 20I as manufactured by PLP Composites, Fitzwilliam, NH 03447.

The flagpole shall have a mounting height of 20'. The butt diameter shall be 5.75" and the top diameter 3". The pole weight shall be approximately 41 lbs. and a total shipping weight of 105 lbs.

The flagpole shall be manufactured of fiberglass woven roving and polyester resin with 75% of the reinforcing fibers oriented in the axial plane for maximum stiffness and 25% in the radial plane for required hoop strength. Load calculations shall be based on AASHTO and NAAMM standards with the pole designed with a two to one (2:1) safety factor for 125 mph windspeed, unflagged, with a 1.3 gust factor.

The flagpole shall have an Entasis taper and shall be void of vertical mold seams.

The flagpole shall be sanded smooth and coated with a high gloss Aliphatic Polyurea coating system which provides extended UV protection and weatherability.

The color of the flagpole shall be:

Standard: white, bronze, black or other, as specified \_\_\_\_\_ (select one)

The flagpole shall be equipped with PLP standard fittings:

- #10 (5/16") polyester halyard
- 8.5" nylon cleat
- a pair of brass snaps with vinyl covers

Anchor base: Cast Aluminum A356 alloy aluminum, the anchor base shall be heat treated to a T6 condition. The shaft shall be epoxied and pinned to an aluminum pipe which shall be inserted in the anchor base casting, casting and shaft shall be joined by continuous circumferential welds at the outside top and inside bottom of the anchor base.

The base requires four anchor bolts with covers and two nuts, two flat washers, and one lock washer per anchor bolt as follows: (sold separately)

- 3/4"x24" anchor bolt
- 2-3/4" exposed thread projection recommended



# Internal Halyard Hinge Base

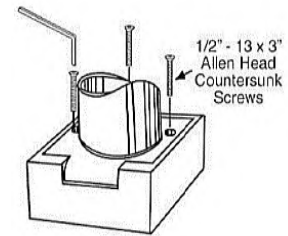
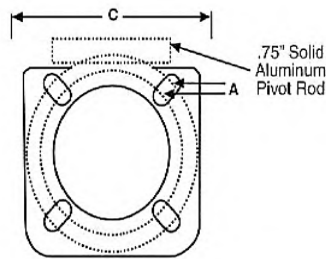
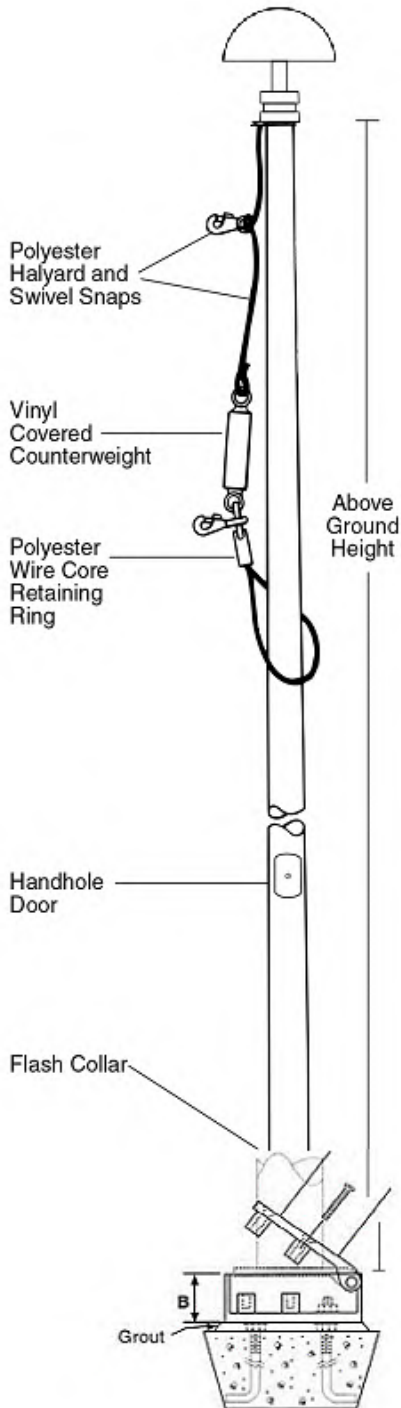

| Model                              | HB20X            | HB25X   | HB30X   |
|------------------------------------|------------------|---------|---------|
| Above Ground Height                | 20'              | 25'     | 30'     |
| Butt Diameter                      | 5.75"            | 6.5"    | 6.5"    |
| Top Diameter                       | 3"               | 3"      | 3"      |
| Pole Weight with base (lbs.)       | 52               | 72      | 89      |
| Shipping Weight with base (lbs.)   | 105              | 118     | 141     |
| Halyard                            | #10              | #10     | #10     |
| Snaps                              | Brass            | Brass   | Brass   |
| Anchor Bolt length (sold separate) | 24"              | 24"     | 24"     |
| Bolt Diameter                      | 3/4"             | 3/4"    | 3/4"    |
| Exposed Thread Projection          | 3"               | 3"      | 3"      |
| Bolt Circle (A)                    | 7.5"-9"          | 8.5"-9" | 8.5"-9" |
| Base Dimensions (B&C)              | 3.5" h x 10.5" w |         |         |
| Standard Flag Size                 | 4'x6'            | 4'x6'   | 5'x8'   |

## Specifications

Provide a Fiberglass Reinforced Composite (FRC) Hinge Base Flagpole Model # HB 20X as manufactured by PLP Composites, Fitzwilliam, NH 03447.

The flagpole shall have a mounting height of 20'. The butt diameter shall be 5.75" and the top diameter 3". The pole weight shall be approximately 52 lbs. and a total shipping weight of 105 lbs.

The flagpole shall be manufactured of fiberglass woven roving and polyester resin with 75% of the reinforcing fibers oriented in the axial plane for maximum stiffness and 25% in the radial plane for required hoop strength. Load calculations shall be based on AASHTO and NAAMM standards with the pole designed with a two to one (2:1) safety factor for 125 mph windspeed, unflagged, with a 1.3 gust factor.

The flagpole shall have an Entasis taper and shall be void of vertical mold seams.

The flagpole shall be sanded smooth and coated with a high gloss Aliphatic Polyurea coating system which provides extended UV protection and weatherability.

The color of the flagpole shall be:

Standard: white, bronze, black or other, as specified \_\_\_\_\_ (select one)

The flagpole shall be equipped with PLP standard fittings:

- polyester halyard
- nylon cleat
- a pair of brass snaps with vinyl covers

Hinge base: Cast Aluminum A356 alloy aluminum, the hinge base shall be heat treated to a T6 condition. The shaft shall be epoxied and pinned to an aluminum pipe which shall be inserted in the anchor base casting, casting and shaft shall be joined by continuous circumferential welds at the outside top and inside bottom of the hinge base. Tilting section of the hinge base shall be held in a vertical position by three 1/2" - 13x3" stainless steel countersunk Allen screws. Allen wrench size 5/16".

The base requires four anchor bolts with covers and two nuts, two flat washers, and one lock washer per anchor bolt as follows: (sold separately)

- 3/4"x24" anchor bolt
- 3" exposed thread projection recommended