



## 24 VOLT INSTALLATION DIAGRAM

Install either 1/2" or 3/4" conduit to appropriate threaded hub provided on the enclosure.

**ANY MODIFICATIONS OR  
DRILLING ADDITIONAL HOLES  
TO THE ENCLOSURE VOIDS  
WARRANTY AND UL LISTING**

A 40 Watt driver is mounted inside.  
Primary will cover 120-277VAC on the **Blue** / **Brown** wires.  
Secondary is 24VDC. Positive VDC is **Red**.  
Negative VDC is Black

\* All cord grips were installed "water-tight" by the factory. When installing secondary lighting load, but sure to tighten load, but sure to tighten the cord grip in order to ensure a water tight connection\*

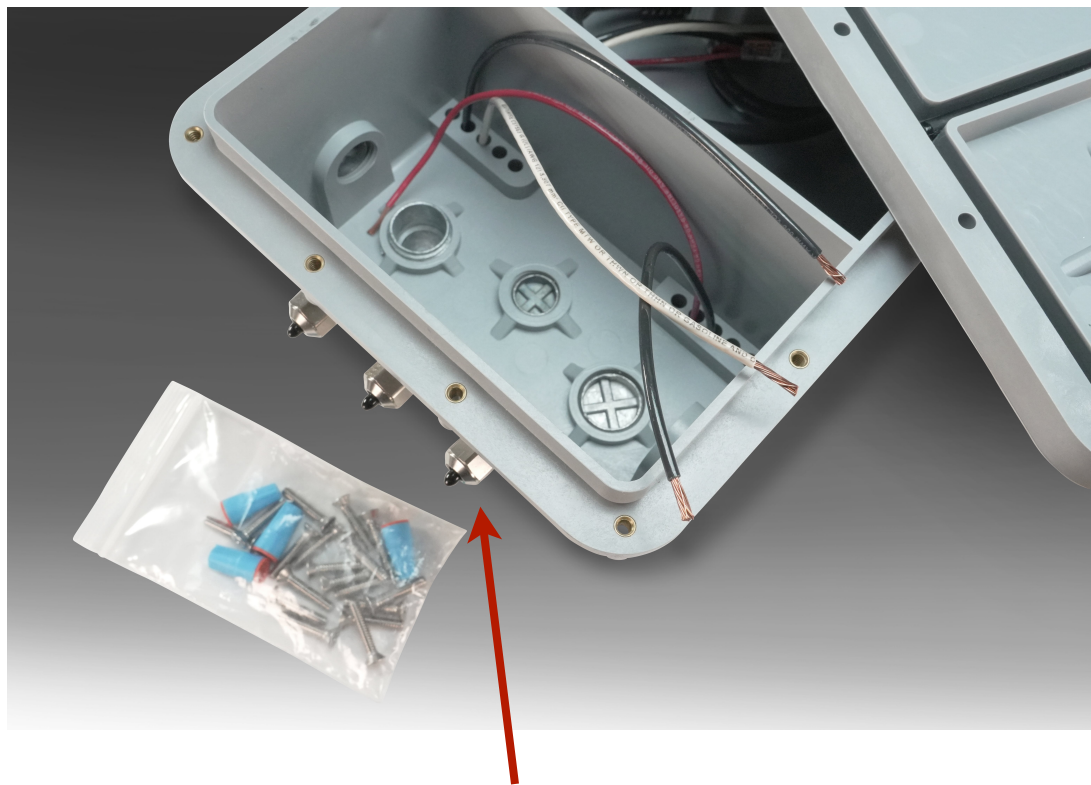

Qty. 3 Liquid-Tight Brass Cordgrips

Each cordgrip comes sealed with a black rubber cap. To use, loosen the cap end and remove / discard the black rubber cap. Feed secondary wire into cordgrip and tighten down to ensure a sealed connection. Leave remaining caps in place if additional cordgrips are not being used.

*\*\* Handtighten unused cordgrips. Do not overtighten.*

